

TEAR ▲

TEAR ▲



ROLLED GAUZE

1 ea. – 4.1 yds x 4.5", six-ply, sterile gauze

CIRCULATION
TM



Step 1: ID and expose wound.

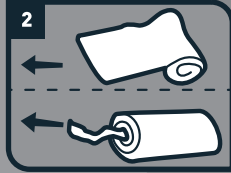

Step 2: To wrap wound, unroll from end. To pack wound, pull from the center.

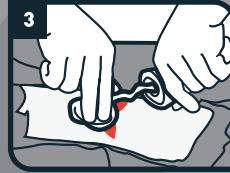

Step 3: Pack or wrap gauze.



Step 4: Apply pressure. Reassess.



Combat Medical
5555 Harrisburg Industrial Park Drive
Harrisburg, NC 28075 USA
1-855-428-6074
www.combatmedicalsyste.ms.com

REF 33-300 CMS-PUB-GAUZE-04-007
Pat. Info: combatmedicalsyste.ms.com/ip
Prod. Info: combatmedicalsyste.ms.com/e-labels
© 2017 Combat Medical Systems, LLC



Made in USA **STERILE R**

WARNINGS: For use by trained medical providers. Contents sterile — **DO NOT USE** if package is opened or damaged. Once applied, patient should be monitored. Dispose of soiled material per biohazard waste guidelines.

▼ TEAR

▼ TEAR

